

# **Burnham Park Workshop Report**

## **October 24, 2019, 5:00 – 8:30pm**

### **El Granada Elementary School Community Room**

#### **Background**

This was the third community outreach event from GCSD, intended to provide community input to planning Burnham Park.

1. June 16, 2018 – informal public event held on Burnham Strip at Obispo Road & Avenue Portola. Public was invited to view conceptual drawing (not “plans” and provide written comments on what amenities they would and would not like to see in a future Burnham Park. Over 70 written comments were recorded and a summary report was presented to the Board at a Special meeting on August 30, 2018. The final report including a summary of the Board discussion is available at [www.granada.ca.gov/parks](http://www.granada.ca.gov/parks).
2. September 2019 – A community interest survey for Parks and Recreation was mailed to all GCSD ratepayers (excluding Frenchman’s Creek area, which is covered for Parks and Recreation by the city of Half Moon Bay). The survey included questions about the importance of developing Burnham Park and the relative importance of 25 specific elements/features. The report from this survey was presented at the GCSD Board meeting on October 17, 2019, and is available as a link at [www.granada.ca.gov/parks](http://www.granada.ca.gov/parks).
3. October 24, 2019 – a noticed public workshop in which community members were asked to prioritize desired park features and map out potential locations for top priorities.

#### **Purpose, Process and Payoff of Burnham Park Workshop**

**Purpose:** Engage community members in a very interactive format to further the Board’s understanding of community vision and priorities for the new Burnham Park. Differentiate the process and perspective gained from the previous outreach and survey.

**Process:** GCSD community was invited to attend an interactive workshop which begins with an informal conversation/pizza hour supported by various background information displays, followed by a brief presentation and then small group activity to work with each other in identifying the most desirable features to be included in Burnham Park and to suggest locations within the park for the highest priority elements/features.

**Payoff:** A third set of community perspectives to augment and compliment the first two Burnham Park community outreach efforts, which has the potential to illuminate the diversity and/or convergence of views across the more highly engaged community members who would choose to attend a workshop, and further provides input on desired locations within the park for the highest priority elements.

#### **Workshop Overview**

Approximately 45 – 50 people attended the workshop. The time commitment, enthusiasm and positive public spirit of all attendees was terrific and greatly appreciated by GCSD!

- 5:00 – 5:45 Community members arrived, enjoy pizza and refreshments, and viewed informational displays from the June 2018 outreach event and September 2019 Community Survey
- 5:45 – 6:00 Community members were organized into five “like minded” work groups, i.e., those who prefer a peaceful, serene park, those who prefer a park with many activities from which to choose, and those who prefer a mix. The work groups ranged from about 6 to 12 members, and were facilitated by Parks Advisory Committee (PAC) volunteers Fran

## Burnham Park Workshop Report

Pollard, Pat Tierney, Michelle Dragony and Paul Koelsch, and GCSD Recreation Coordinator Claudia Marshall. One additional table was available for kids. Several kids participated in the voting, and two kids ages 8 and 11 volunteered to do the mapping and reporting at this table.

- 6:00 – 6:20 GCSD Board President Matthew Clark welcomed residents; VP Barbara Dye provided information on GCSD Parks & Recreation funding and noted that the workshop would not address issues raised previously regarding the CalTrans easement and the need for a safe Highway 1 crossing to Surfers Beach. PAC Chair Nancy Marsh reviewed the plan for the work group voting and mapping process. Steve Kikuchi from Landscape architects Kikuchi + Kankel provided an overview of the “constraints map” for the Burnham Strip property, including considerations of wind, sound, ocean views and sun direction.
- 6:20 – 6:40 Work group members were provided a chart with trail, parking and features/elements options for the park (the same options that were used in the Community Survey) and were asked to vote on them using colored sticky dots: Green = “I want it in the park”; Yellow = “Not important to me but don’t mind if it’s included”; Red = “I don’t want it in the park”. Each item was scored and ranked from most to least favored items to guide the group’s priorities for the mapping effort. Scoring was done as “number of green dots minus number of red dots = score.” Items with more red than green dots have a negative score. **NOTE:** the tabulated scores are not intended to be a quantitative measure of overall popularity – some people did not vote on every item, and others put more than one vote on the same item. The Community Survey is a better indicator of broad community preferences. (See Appendix A)
- 6:40 – 7:30 Each work group discussed and agreed placement of each item of a large (approximate 3 x 6 feet) map of the Burnham Strip property, starting with their most favored items. The map was marked with grid squares scaled to 20’x20’, and the group was provided with a table of the appropriate number of grid squares to use for each item. A member of the group first outlined each element with pencil, then when the group was satisfied with all placements, the elements were outlined and labelled with a Sharpie. (See Appendix B)
- 7:30 – 8:00 A spokesperson for each group, including the kid’s table, presented their map. (See Appendix B).
- 8:00 – 8:10 Board member David Seaton thanked participants and closed the meeting, noting that next steps would include further planning and opportunities for community review and feedback.

The workshop was videotaped and will be available on YouTube through PacificTV. The scores from all six voting charts have been recorded and the large maps have been scanned for safekeeping. All of the output from all three Burnham Park Community Outreach events will be considered in ongoing planning for Burnham Park.

**Parks Advisory Committee Recommendations**

Following the Burnham Park Public Workshop, the PAC held a regular public meeting on Tuesday, November 5. The committee discussed what went well, what could be improved and what was learned in delivering the Public Workshop:

- Went well: good organization and preparation led to minimal confusion; the like-minded cohorts revealed a range of community views; great community participation; the creativity (especially related to parking) and ideas for placement of various features was new information not gathered in the prior public outreach events.
- What to improve: watch for anarchy 😊 – some people voted in more than one group or voted for a feature more than one time, which limits the validity of any inferences from the voting tabulations; the cut-out pieces representing features-to-scale worked well in the group that created them.
- Key Learnings: the “active” group (Table 6) demonstrated that everything on the features list could be included and still have a generally open feel to the park, satisfying the divergent perspectives in the community; the perspectives gained from this workshop must be integrated with the data drawn from the prior outreach efforts, particularly the Community Survey which gathered the broadest range of views with over 500 responses.
- Additional Thoughts - the next outreach should be on the Burnham strip property to continue to develop community perception of the spaciousness of the property and the impact of various features; remember accessibility, which was not addressed in the workshop (e.g. consider a true multi-use paved perimeter trail); think about lighting, both low level path lighting and timer based features lighting, e.g. for skate ramp or half-court, that would allow use in the early winter evenings; a “skate” park could be a multi-use design that would support skateboards, scooters and small BMX-type bikes, which would extend the age-range from very small kids to adults.

Following a broad discussion, PAC passed 2 motions for recommendations to the GCSD Board:

1. PAC unanimously recommends to the GCSD Board that data from the three outreach efforts is sufficient to move to actual draft design as soon as is practical.
2. PAC recommends, on a vote of 5-1\*, to the GCSD Board that the following features, in logical groupings, should be included in the draft design:

Restroom/showers	Perimeter Trail with fitness stations and interpretive signs	Benches, some placed to highlight quiet and views, and art	Native vegetation throughout
Picnic area with barbecues	Plaza that could accommodate musical performances	Children’s Playground (accessible elements), climbing boulders	Skate/scoot/bike park and half-pipe
Half-Court Basketball		Lawn Area	

\*One member dissented based on objection to inclusion of some of these elements.

PAC also recommends that this report should be posted on [www.granada.ca.gov/parks](http://www.granada.ca.gov/parks) alongside reports from the prior two Burnham Park outreach events.

**Appendix 1: Voting Chart Tallies**

**Burnham Park Workshop  
Features/Elements Votes Chart  
Summary of Feature Scores Descending Order**

**Dot Vote Definitions:**  
**GREEN:** I want it in the park  
**YELLOW:** Not important to me but don't mind if it's included  
**RED:** I don't want it in the park

*NOTE: the purpose of this voting was to prioritize items to be mapped; the total scores are not intended to be a measure of overall popularity – some people did not vote on every item, and others put more than one vote on the same item. The Community Survey is a better quantitative indicator of broad community preferences.*

**Trail Options – Draw these on the map free-hand**

Option	Table 1 Fran	Table 3 Claudia	Table 4 Pat	Table 5 Michelle	Table 6 Paul	Kids Table	Total
Perimeter Park Trail	4	3	4	5	3		19
Internal Park Trails	2	4	3	8	1		18

**Parking Options – Use the Scale Key to draw these on the map**

Option	Table 1 Fran	Table 3 Claudia	Table 4 Pat	Table 5 Michelle	Table 6 Paul	Kids Table	Total
Same Size as Current Lot	1	5	1	2	3		12
Larger than Current Lot	-5	-2	3	-2	13		7
Smaller than Current Lot	4	-1	-2	6	-6		1

**Elements/Features – Use the Scale Key to draw these on the map**

Option	Table 1 Fran	Table 3 Claudia	Table 4 Pat	Table 5 Michelle	Table 6 Paul	Kids Table	Total
Restrooms	2	7	9	10	16	6	50
Skate Ramp – half-pipe	2	7	11	5	19	6	50
Skate Park - small, below ground	4	0	7	8	16	8	43
Children’s Playground	4	1	6	6	13	7	37
Outdoor Showers	0	5	5	13	10	3	36
Lawn Area	-1	5	6	7	9	3	29
Fitness (Parkours) & Running Circuit	6	0	4	7	3	6	26
Picnic Area – Family	4	6	2	6	2	3	23
Picnic Area – Group	2	-1	2	0	12	4	19
Half-Court Basketball	-4	-2	4	2	9	6	15
Multi-Sport Court	-1	-3	0	1	9	9	15
Climbing Boulders	-1	-2	-1	7	3	8	14
Bocce Court	3	2	0	6	-3	4	12
Bicycle Pump Track	-6	-4	0	2	11	8	11
Horseshoes Area	3	1	0	-2	2	4	8
Small Amphitheatre/Stage	0	2	2	2	-5	2	3
Plaza	4	3	-2	-3	-4	2	0
Dog Park – fenced, off leash	-4	-1	-2	-3	4	5	-1

Additional small features considered in the Parks & Recreation Community Survey, and which may be included in draft plans: Art, Barbecues, Benches, Interpretive Signs, Native Vegetation Area, Ocean Views, Quiet Area

**Appendix B: Work Group Maps**

Kids Table (Gavin & Jasper)

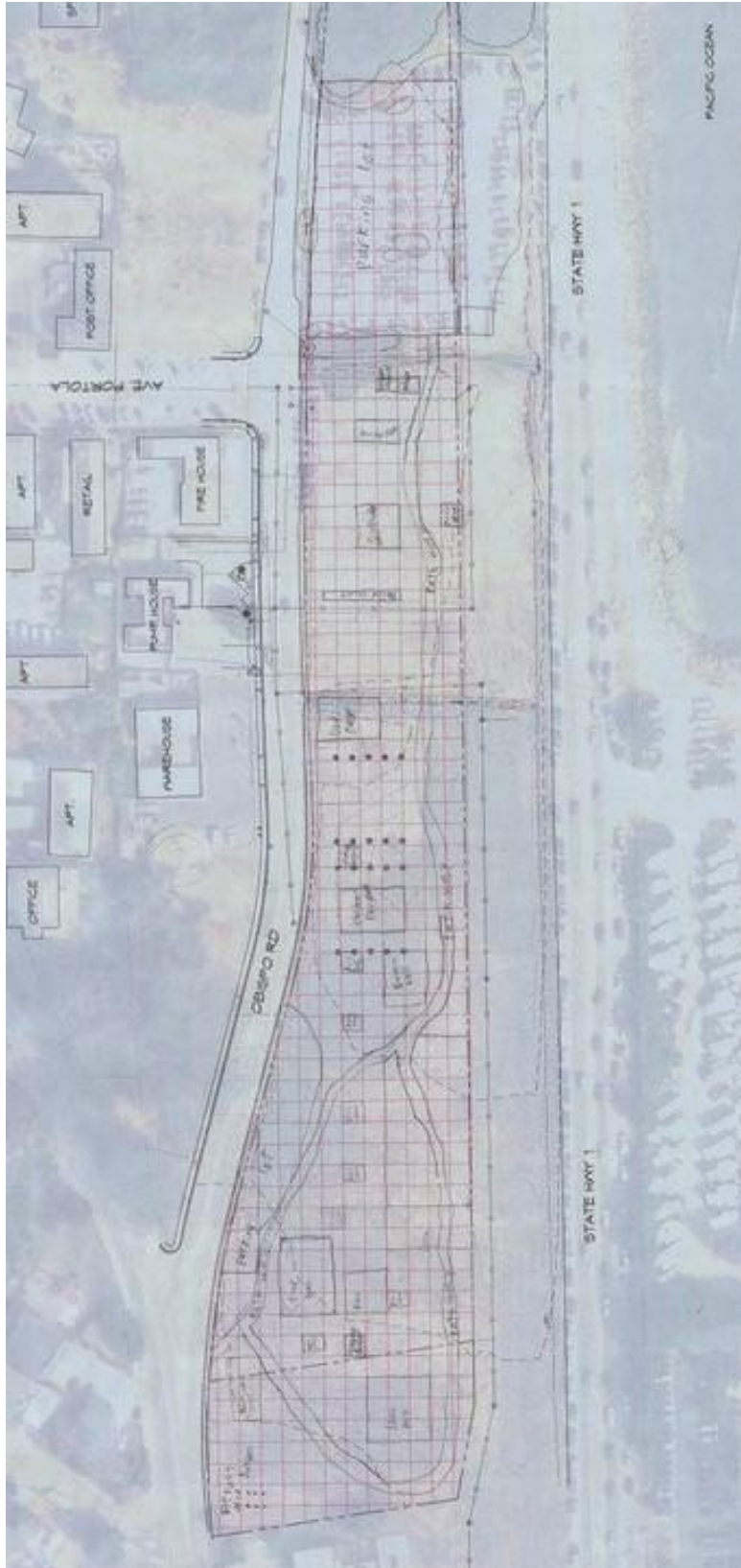



Table 1 – Fran

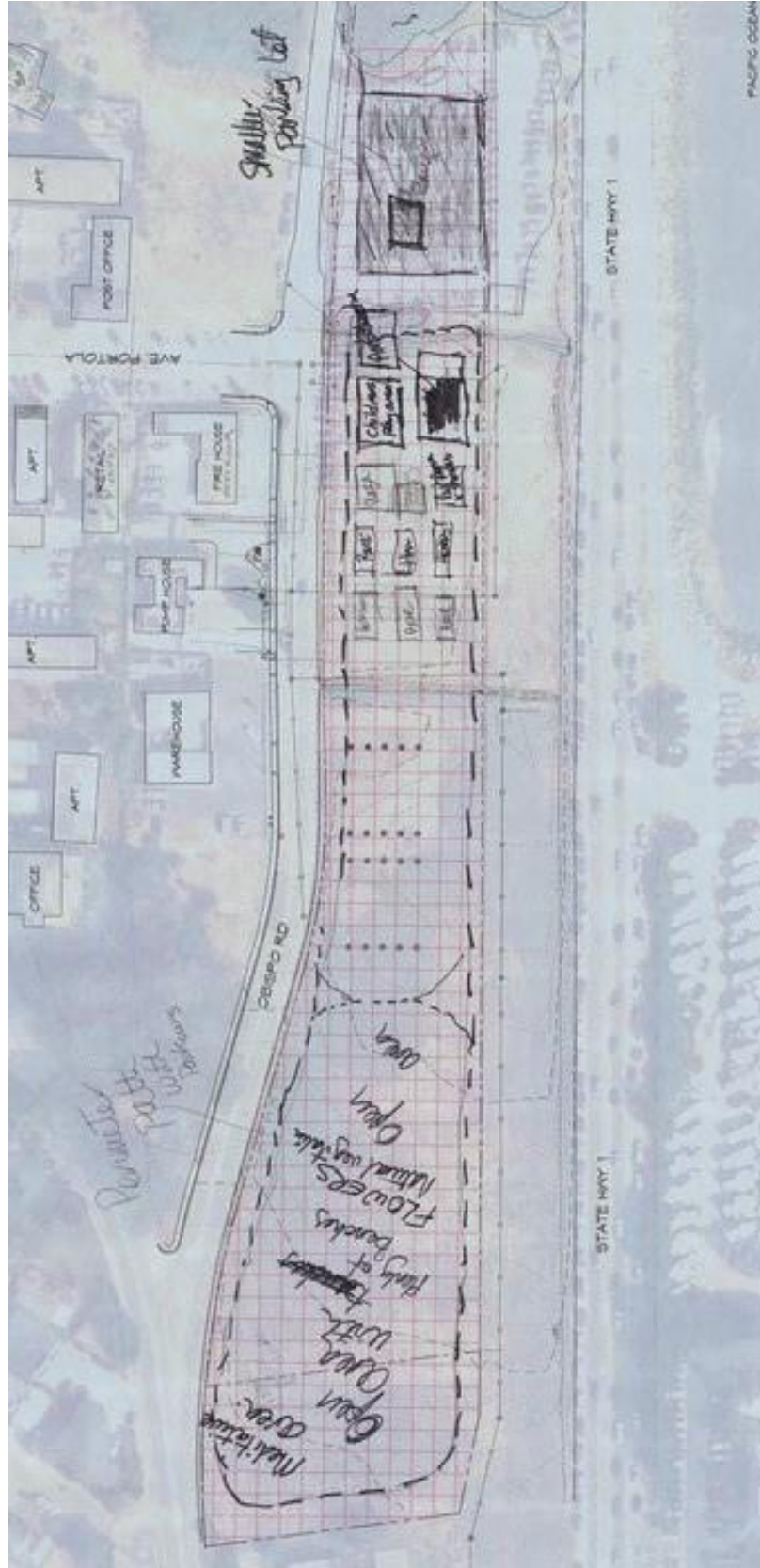

Table 3 – Claudia

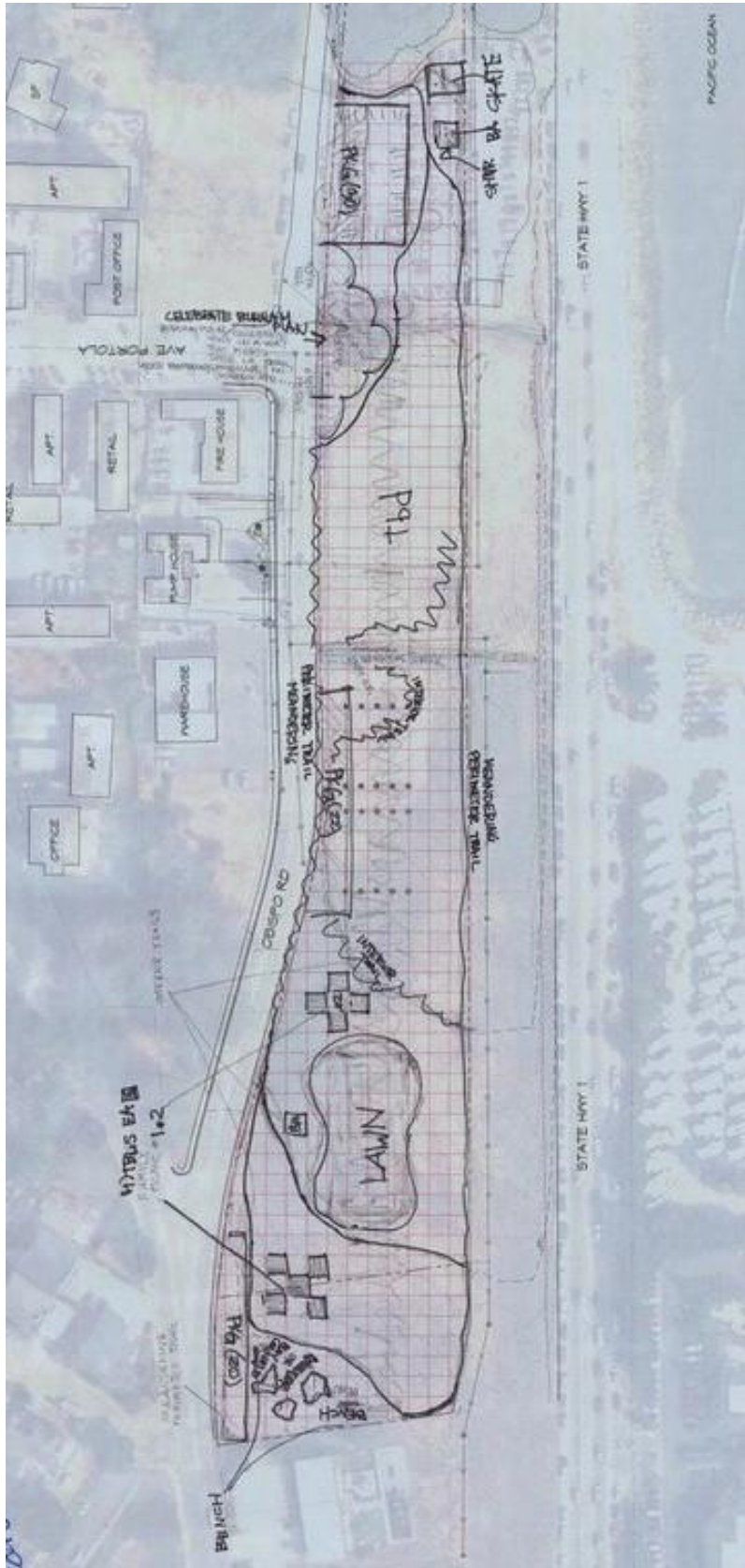

Table 4 – Pat

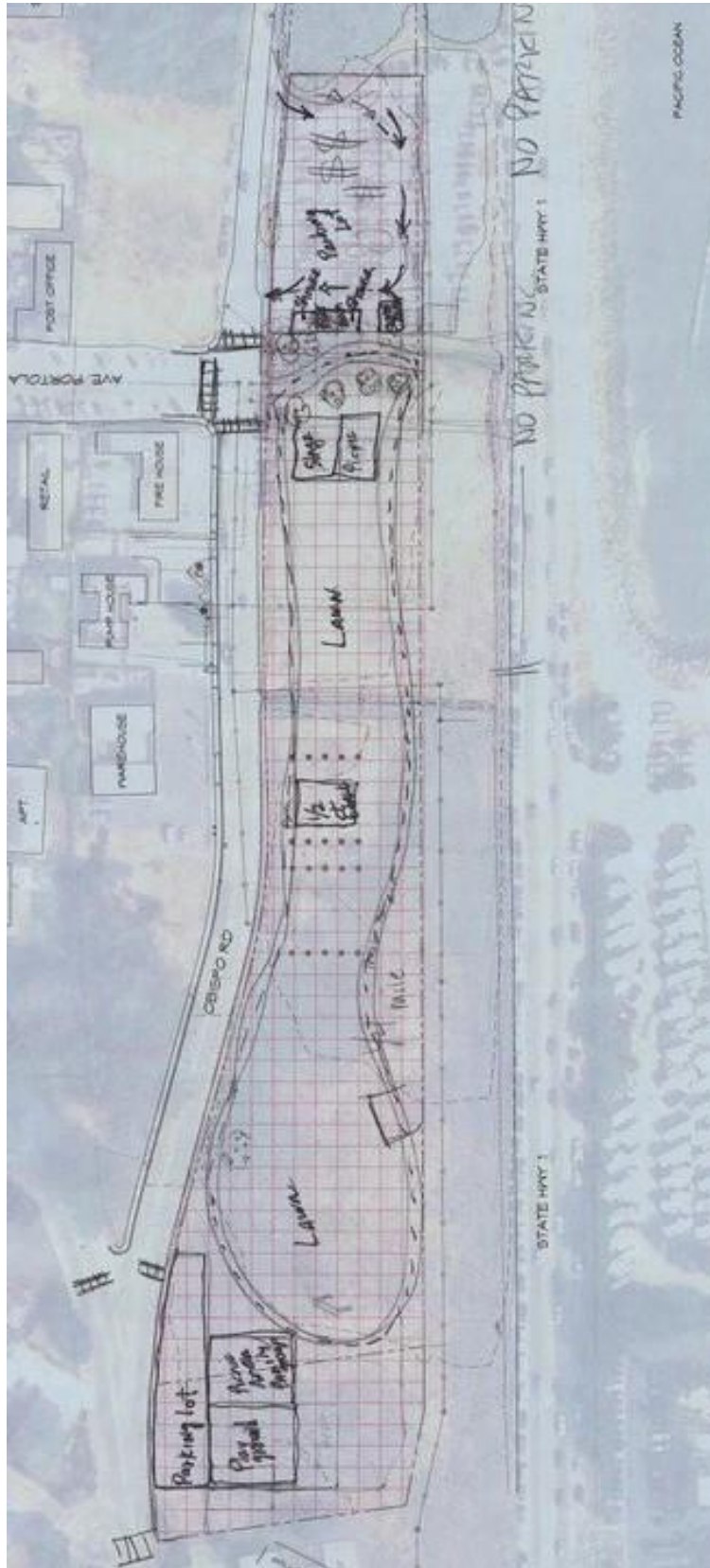



Table 5 – Michelle



Table 6 – Paul

